

ROZVINUTÝ POHLED

Abwicklung
flat pattern

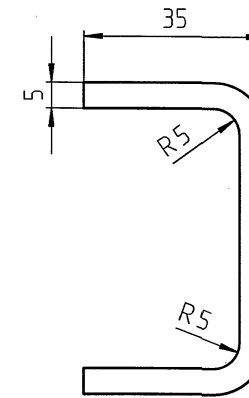
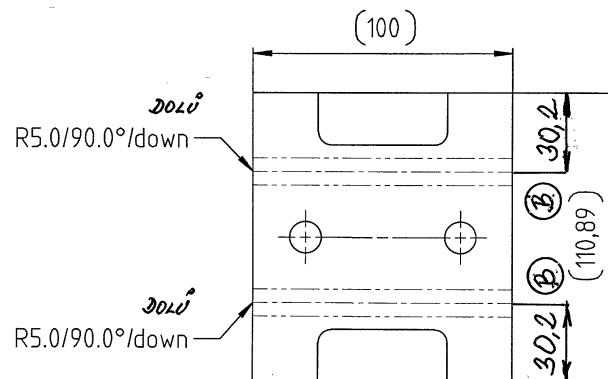

PŘEKLAD

dne: - 8 -02- 2017

PROVEDL/A
JANA PROKEŠOVÁ

14-02-2017
ARCHIV

ZM/17/00134

1

Konečné rozměry jsou závazné.
Výkres musí být upraven v souladu s metodou hran.

Achtung
Fertigmaße sind verbindlich
Maße der Abwicklung nicht bindend
Abwicklung dem Kantverfahren anpassen

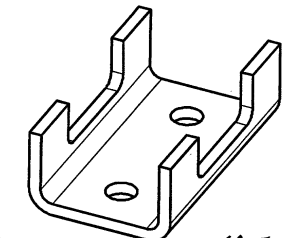

② ZM/17/00134 DOPLNĚNÝ OSY OHYBU ZMĚNA PR. DÍRY Z 12,5 NA 12,8 2x
Important
Finish dimensions are binding
The drawing must be adapted according to the edge method

BEZ LAKU
Ohne Beschichtung
KWN 2186915

| | | | | | | | |
|--------------------------------------|--|-------------|--|------------------|--|-------------------|--|
| REFER TO PROTECTION NOTICE ISO 16016 | | MATERIAL | | TYPE DOCUMENT-NO | | VERS STATUS | |
| HSTG | | ECN-NO | | MAT-SPEC. | | UGD 5223645 | |
| ISO 8015 | | ISO 14405 | | DATE | | 07.11.2016 | |
| ISO 2768 | | m/K | | NAME | | KLKAZMAIERB | |
| ISO 13920 | | BF | | APPROVED BY | | LAST MODIFIED BY | |
| ISO 8062 | | CT10 | | DATE | | 07.11.2016 | |
| ISO 9013 | | 231 | | NAME | | KLKAZMAIERB | |
| ISO 1101 | | EN ISO 1302 | | DESCRIPTION | | Halteblech Sensor | |
| KWN 2188113 | | | | | | Bracket sensor | |
| | | | | | | PART NO | |
| | | | | | | 2563370 | |
| | | | | | | REV NO | |
| | | | | | | - | |